

IMPACT SOCKETS

1/2, 3/4, 1 & 1-1/2" SQUARE DRIVE



1/2"

6-Point Standard

Type	A/F mm	DRWG	D1 mm	D2 mm	L mm	L2 mm
D02012-0-008	8	A	14.5	24	38	9
D02012-0-009	9	A	16	24	38	12
D02012-0-010	10	A	17	24	38	12
D02012-0-012	12	A	20	24	38	12
D02012-0-013	13	A	21	24	38	12
D02012-0-014	14	A	22	24	38	12
D02012-0-015	15	A	24	24	38	12
D02012-0-016	16	A	25	26	38	12
D02012-0-017	17	A	26	26	38	13
D02012-0-018	18	A	27.5	28	38	13
D02012-0-019	19	A	29	30	38	13
D02012-0-021	21	B	32	32	38	13
D02012-0-022	22	C	32	32	38	13
D02012-0-024	24	C	35	36	45	20
D02012-0-025	25	C	36	36	45	20
D02012-0-027	27	C	39	38	50	22
D02012-0-028	28	C	40	38	50	22
D02012-0-030	30	C	42.5	38	50	22

Long Length



Type	A/F mm	DRWG	D1 mm	D2 mm	L mm	L2 mm
D02012-1-008	8	A	14.5	24	78	13
D02012-1-009	9	A	16	24	78	14
D02012-1-010	10	A	17	24	78	14
D02012-1-012	12	A	20	24	78	14
D02012-1-013	13	A	21	24	78	14
D02012-1-014	14	A	22	24	78	17
D02012-1-015	15	A	24	24	78	17
D02012-1-016	16	A	25	26	78	17
D02012-1-017	17	A	26	26	78	17
D02012-1-018	18	A	27.5	28	78	17
D02012-1-019	19	A	29	30	78	19
D02012-1-021	21	B	32	32	78	24
D02012-1-022	22	C	32	32	78	24
D02012-1-024	24	C	35	36	78	24
D02012-1-025	25	C	36	36	78	24
D02012-1-027	27	C	39	38	78	54
D02012-1-028	28	C	40	38	78	54
D02012-1-030	30	C	42.5	38	78	54

Socket Dimensional Drawing

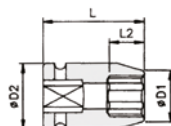

DRAWING A

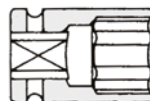

DRAWING B

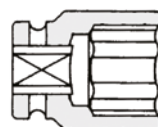

DRAWING C

3/4"

6-Point Standard

Type	A/F mm	DRWG	D1 mm	D2 mm	L mm	L2 mm
D03034-0-013	13	A	25	44	50	9
D03034-0-017	17	A	31	44	50	12
D03034-0-018	18	A	32	44	50	13
D03034-0-019	19	A	33	44	50	13
D03034-0-021	21	A	36	44	50	15
D03034-0-022	22	A	37	44	50	15
D03034-0-024	24	A	40	44	50	16
D03034-0-027	27	A	43	44	54	16
D03034-0-030	30	C	47	44	54	21
D03034-0-032	32	C	49	44	56	21
D03034-0-033	33	C	51	44	56	22
D03034-0-036	36	C	54	44	56	22
D03034-0-038	38	C	57	44	58	24
D03034-0-041	41	C	61	44	58	24
D03034-0-046	46	C	67	44	63	27
D03034-0-050	50	C	71	54	72	35

Long Length



Type	A/F mm	DRWG	D1 mm	D2 mm	L mm	L2 mm
D03034-1-013	13	A	25	44	95	133
D03034-1-017	17	A	31	44	95	17
D03034-1-018	18	A	32	44	95	18
D03034-1-019	19	A	33	44	95	19
D03034-1-021	21	A	36	44	95	21
D03034-1-022	22	A	37	44	95	22
D03034-1-024	24	A	40	44	95	24
D03034-1-027	27	A	43	44	95	27
D03034-1-030	30	C	47	44	95	30
D03034-1-032	32	C	49	44	95	32
D03034-1-033	33	C	51	44	95	33
D03034-1-036	36	C	54	44	95	36
D03034-1-038	38	C	57	44	95	38
D03034-1-041	41	C	61	44	95	38
D03034-1-046	46	C	67	44	95	38
D03034-1-050	50	C	71	54	95	38

Socket Dimensional Drawing

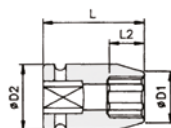

DRAWING A

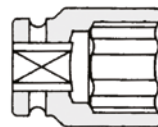

DRAWING C



6-Point Standard

Type	A/F mm	DRWG	D1 mm	D2 mm	L mm	L2 mm
D04010-0-017	17	A	34	54	58	12
D04010-0-019	19	A	35.5	54	58	13
D04010-0-022	22	A	40	54	58	15
D04010-0-024	24	A	42	54	58	19
D04010-0-027	27	A	46	54	58	19
D04010-0-028	28	A	47	54	58	19
D04010-0-029	29	A	48	54	60	19
D04010-0-030	30	A	50	54	60	21
D04010-0-032	32	A	52	54	60	21
D04010-0-033	33	A	53	54	60	21
D04010-0-036	36	C	57	54	65	25
D04010-0-038	38	C	59.5	54	67	25
D04010-0-042	42	C	65	54	74	27
D04010-0-046	46	C	69.5	54	74	30
D04010-0-050	50	C	74	54	80	35
D04010-0-055	55	C	81	54	84	35
D04010-0-060	60	C	87	54	87	42



Long Length

Type	A/F mm	DRWG	D1 mm	D2 mm	L mm	L2 mm
D04010-1-017	17	A	34	54	100	21
D04010-1-019	19	A	35.5	54	100	21
D04010-1-022	22	A	40	54	100	21
D04010-1-024	24	A	42	54	100	21
D04010-1-027	27	A	46	54	100	23
D04010-1-028	28	A	47	54	100	23
D04010-1-029	29	A	48	54	100	50
D04010-1-030	30	A	50	54	100	50
D04010-1-032	32	A	52	54	100	50
D04010-1-033	33	A	53	54	100	50
D04010-1-036	36	C	57	54	100	64
D04010-1-038	38	C	59.5	54	100	64
D04010-1-042	42	C	65	54	100	64
D04010-1-046	46	C	69.5	54	100	62
D04010-1-050	50	C	74	54	100	62
D04010-1-055	55	C	81	54	100	60
D04010-1-060	60	C	87	54	105	77

Socket Dimensional Drawing

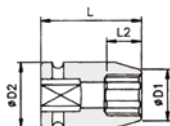

DRAWING A

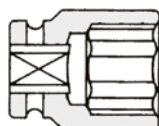

DRAWING C



6-Point Standard

Type	A/F mm	DRWG	D1 mm	D2 mm	L mm	L2 mm
D05112-0-041	41	A	70	86	80	26
D05112-0-046	46	A	76	86	84	27
D05112-0-050	50	A	81	87	87	29
D05112-0-055	55	B	86	86	90	36
D05112-0-056	56	B	86	86	92	38
D05112-0-060	60	C	93	86	92	38
D05112-0-065	65	C	97	86	95	40
D05112-0-070	70	C	105	86	100	43
D05112-0-075	75	C	110	86	103	45
D05112-0-080	80	C	116	86	110	50
D05112-0-085	85	C	125	86	118	55



Long Length

Type	A/F mm	DRWG	D1 mm	D2 mm	L mm	L2 mm
D05112-1-041	41	A	70	86	115	30
D05112-1-046	46	A	76	86	115	34
D05112-1-050	50	A	81	87	135	36
D05112-1-055	55	B	86	86	140	37
D05112-1-056	56	B	86	86	140	37
D05112-1-060	60	C	93	86	150	41
D05112-1-065	65	C	97	86	150	45
D05112-1-070	70	C	105	86	160	47
D05112-1-075	75	C	110	86	170	51
D05112-1-080	80	C	116	86	170	51
D05112-1-085	85	C	125	86	170	56

Socket Dimensional Drawing

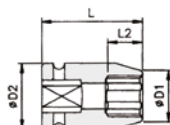

DRAWING A

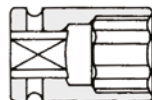

DRAWING B

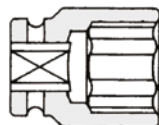

DRAWING C

Extension Bars with pin-hole

Type	Square-drive	DRWG	D2 mm	L mm
D07012-0-150	1/2"	D	25	150
D07012-0-300	1/2"	D	25	300
D07034-0-150	3/4"	D	44	150
D07034-0-330	3/4"	D	44	330
D07100-0-150	1"	D	54	150
D07100-0-300	1"	D	54	300
D07112-0-125	1 1/2"	D	86	125
D07212-0-250	1 1/2"	D	86	250

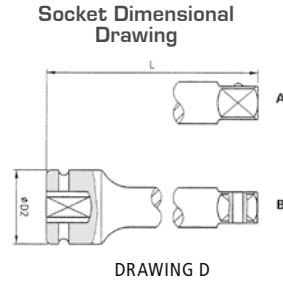

Adaptors with pin-hole

Type	Square-drive	Outside	DRWG	D2 mm	L mm
D08012-0-034	1/2"	3/4"	E	30	48
D08034-0-012	3/4"	1 1/2"	E	40	58
D08034-0-100	3/4"	1"	E	40	63
D08100-0-034	1"	3/4"	E	52	80

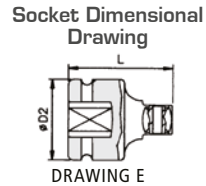

Pins and Rings

Type	Square-drive
D01012-0-000	1/2"
D01034-0-000	3/4"
D01100-0-000	1"
D01112-0-000	1 1/2"

